

Fuel system quick connector



A10 6.30-ID6 Rubber E 90°



Fits to ID-6 mm rubber hose

Continuous Working T°: -30°C to 120°C
Working Pressure: 5-7bars

A11 6.30-ID8 Rubber S 0°



Fits to ID-8 mm rubber hose

Continuous Working T°: -30°C to 120°C
Working Pressure: 5-7bars

A12 6.30-ID8 Rubber E 90°



Fits to ID-8 mm rubber hose

Continuous Working T°: -30°C to 120°C
Working Pressure: 5-7bars

AF1 6.30 Dust cap



Suitable for 6.30 Series Connectors

AS1 6.30 Safety lock



Suitable for 6.30 Series Connectors

A60 6.30-ID6 Lengthen M. 0°



Fir Tree OD- - 8.9mm

Fits to ID-6 mm nylon hose

Continuous Working T°: -30°C to 120°C
Working Pressure: 5-7bars

A50 6.30-ID6 Male 0°



Fir Tree OD--8.9mm

Fits to ID-6 mm nylon hose

Continuous Working T°: -30°C to 120°C
Working Pressure: 5-7bars

AD1 6.30 Female end cap



Fits to 6.30 Series male Connector

Continuous Working T°: -30°C to 120°C
Working Pressure: 5-7bars

AD2 6.30 Male end cap



Fits to 6.30 Series Female Connector or Tube plug.

Continuous Working T°: -30°C to 120°C
Working Pressure: 5-7bars

Fuel system quick connector



B1 7.89-ID6 Straight 0°



Fir Tree OD--8.9mm

Fits to ID-6 mm nylon hose

Continuous Working T°: -30°C to 120°C
Working Pressure: 5-7bars

B2 7.89-ID6 Elbow 90°



Fir Tree OD--8.9mm

Fits to ID-6 mm nylon hose

Continuous Working T°: -30°C to 120°C
Working Pressure: 5-7bars

B3 7.89-ID8 Straight 0°



Fir Tree OD--10.9mm

Fits to ID-8 mm nylon hose

Continuous Working T°: -30°C to 120°C
Working Pressure: 5-7bars

B4 7.89-ID8 Elbow 90°



Fir Tree OD--10.9mm

Fits to ID-8 mm nylon hose

Continuous Working T°: -30°C to 120°C
Working Pressure: 5-7bars

B5 7.89-ID6 45° 45°



Fir Tree OD--8.9mm

Fits to ID-6 mm nylon hose

Continuous Working T°: -30°C to 120°C
Working Pressure: 5-7bars

B6C 7.89-ID6 90° lengthen tee



Fir Tree OD--8.9mm

Fits to ID-6 mm nylon hose

Continuous Working T°: -30°C to 120°C
Working Pressure: 5-7bars

B6 7.89-ID6 90° Male tee



Fir Tree OD--8.9mm

Fits to ID-6 mm nylon hose

Continuous Working T°: -30°C to 120°C
Working Pressure: 5-7bars

B7 7.89-ID6 90° Tee



Fir Tree OD--8.4mm

Fir Tree OD--8.4mm

Fits to ID-6 mm nylon hose

Continuous Working T°: -30°C to 120°C
Working Pressure: 5-7bars

B8 7.89-ID3 Straight 0°



Fir Tree OD--5.4mm

Fits to ID-3 mm nylon hose

Continuous Working T°: -30°C to 120°C
Working Pressure: 5-7bars

Fuel system quick connector



B9 7.89-ID3 Elbow 90°



Fir Tree OD--5.4mm

Fits to ID-3 mm nylon hose

Continuous Working T°: -30°C to 120°C
Working Pressure: 5-7bars

B10 7.89-ID4 Straight 0°



Fir Tree OD--5.4mm

Fits to ID-4 mm nylon hose

Continuous Working T°: -30°C to 120°C
Working Pressure: 5-7bars

B11 7.89-ID4 Elbow 90°



Fir Tree OD--5.4mm

Fits to ID-4 mm nylon hose

Continuous Working T°: -30°C to 120°C
Working Pressure: 5-7bars

B12 7.89-ID6 Rubber S 0°



Fir Tree OD--6.8mm

Fits to ID-6 mm Rubber hose

Continuous Working T°: -30°C to 120°C
Working Pressure: 5-7bars

B13 7.89-ID6 Rubber E 90°



Fir Tree OD--6.8mm

Fits to ID-6 mm Rubber hose

Continuous Working T°: -30°C to 120°C
Working Pressure: 5-7bars

B14 7.89-ID5 Straight 0°



Fir Tree OD--6.5mm

Fits to ID-5 mm nylon hose

Continuous Working T°: -30°C to 120°C
Working Pressure: 5-7bars

B15 7.89-ID5 Elbow 90°



Fir Tree OD--6.5mm

Fits to ID-5 mm nylon hose

Continuous Working T°: -30°C to 120°C
Working Pressure: 5-7bars

B16 7.89-ID6 -45 45°



Fir Tree OD--8.9mm

Fits to ID-6 mm nylon hose

Continuous Working T°: -30°C to 120°C
Working Pressure: 5-7bars

B17 7.89-ID6 Straight 0°



Fir Tree OD--8.9mm

Fits to ID-6 mm nylon hose

Continuous Working T°: -30°C to 120°C
Working Pressure: 5-7bars

Fuel system quick connector



B18 7.89-ID6 Elbow 90°

Fir Tree OD--8.9mm

Fits to ID-6 mm nylon hose
 Continuous Working T°: -30°C to 120°C
 Working Pressure: 5-7bars

B19 7.89-7.89 90° Tee

7.89 Male Profile

7.89 Male Profile

Continuous Working T°: -30°C to 120°C
 Working Pressure: 5-7bars

B20 7.89-ID6-7.89 90° T-M

Fir Tree OD--8.9mm

7.89 Male Profile

Fits to ID-6 mm nylon hose
 Continuous Working T°: -30°C to 120°C
 Working Pressure: 5-7bars

B21 7.89-ID6 Equal Tee

Fir Tree OD--8.9mm

Fir Tree OD--8.9mm

Fits to ID-6 mm nylon hose
 Continuous Working T°: -30°C to 120°C
 Working Pressure: 5-7bars

B22 7.89-ID6 M-T- Tee

Fir Tree OD--8.9mm

7.89 Male Profile

Fits to ID-6 mm nylon hose
 Continuous Working T°: -30°C to 120°C
 Working Pressure: 5-7bars

B23 7.89-ID10 Straight 0°

Fir Tree OD--12.9mm

Fits to ID-10 mm nylon hose
 Continuous Working T°: -30°C to 120°C
 Working Pressure: 5-7bars

B24 7.89-ID10 Elbow 90°

Fir Tree OD--12.9mm

Fits to ID-10 mm nylon hose
 Continuous Working T°: -30°C to 120°C
 Working Pressure: 5-7bars

B25 7.89-ID8 Rubber S 0°

Fir Tree OD--10.9mm

Fits to ID-8 mm Rubber hose
 Continuous Working T°: -30°C to 120°C
 Working Pressure: 5-7bars

B26 7.89-ID8 Rubber E 90°

Fir Tree OD--10.9mm

Fits to ID-8 mm Rubber hose
 Continuous Working T°: -30°C to 120°C
 Working Pressure: 5-7bars

Fuel system quick connector



B27 7.89-ID8 Rubber-45 45°

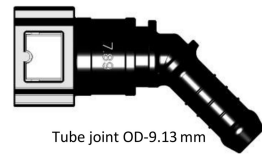

Tube joint OD-9.13 mm

Fits to ID-8 mm Rubber hose

Continuous Working T°: -30°C to 120°C
Working Pressure: 5-7bars

B28 7.89-ID6 Rubber-45 45°

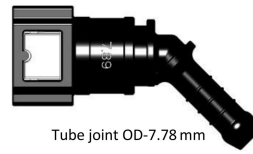

Tube joint OD-7.78 mm

Fits to ID-6 mm Rubber hose

Continuous Working T°: -30°C to 120°C
Working Pressure: 5-7bars

B29 7.89-ID8-7.89 T Tee

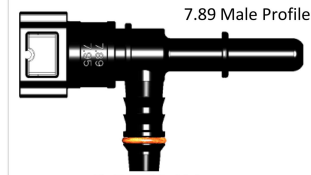

7.89 Male Profile

Fir Tree OD-10.9mm

Fits to ID-8 mm nylon hose

Continuous Working T°: -30°C to 120°C
Working Pressure: 5-7bars

B30 7.89-ID8 Elbow-45 45°



Fir Tree OD-10.9mm

Fits to ID-8 mm nylon hose

Continuous Working T°: -30°C to 120°C
Working Pressure: 5-7bars

BF3 7.89-ID8 Straight check valve



Fir Tree OD-10.9mm

Fir Tree OD-6.8mm

Fits to ID-8 mm nylon hose

Continuous Working T°: -30°C to 120°C
Working Pressure: 5-7bars

B7s 7.89-ID6 90° O Ring Tee 0°



Fir Tree OD--8.4mm

Fir Tree OD-8.4mm

Fits to ID-6 mm nylon hose

Continuous Working T°: -30°C to 120°C
Working Pressure: 5-7bars

B32 7.89-ID6 Straight 0°



Fir Tree OD-8.46 mm

Fits to ID-6 mm nylon hose

Continuous Working T°: -30°C to 120°C
Working Pressure: 5-7bars

B33 7.89-ID6 Elbow 90°



Fir Tree OD-8.46 mm

Fits to ID-6 mm nylon hose

Continuous Working T°: -30°C to 120°C
Working Pressure: 5-7bars

B34 7.89-ID5 Elbow-45 45°



Fir Tree OD-8.46 mm

Fits to ID-5 mm nylon hose

Continuous Working T°: -30°C to 120°C
Working Pressure: 5-7bars

Fuel system male quick connector



B50 7.89-ID6 Straight M



Fir Tree OD--8.9mm

Fits to ID-6 mm nylon hose
 Continuous Working T°: -30°C to 120°C
 Working Pressure: 5-7bars

B51 7.89-ID8 Straight M



Fir Tree OD--10.9mm

Fits to ID-8 mm nylon hose
 Continuous Working T°: -30°C to 120°C
 Working Pressure: 5-7bars

B53 7.89-ID8 Lengthen M



Fir Tree OD--10.9mm

Fits to ID-8 mm nylon hose
 Continuous Working T°: -30°C to 120°C
 Working Pressure: 5-7bars

B54 7.89-ID8 Rubber M



Tube joint OD-8.2mm

Fits to ID-8 mm Rubber hose
 Continuous Working T°: -30°C to 120°C
 Working Pressure: 5-7bars

B55 7.89-ID6 Rubber M



Tube joint OD-6.2mm

Fits to ID-6 mm Rubber hose
 Continuous Working T°: -30°C to 120°C
 Working Pressure: 5-7bars

B56 7.89-ID4 M



Fir Tree OD--5.4mm

Fits to ID-4 mm nylon hose
 Continuous Working T°: -30°C to 120°C
 Working Pressure: 5-7bars

B57 7.89-ID3 M



Tube joint OD-5.4mm

Fits to ID-3 mm nylon hose
 Continuous Working T°: -30°C to 120°C
 Working Pressure: 5-7bars

B64 7.89-ID10 M



Fir Tree OD-12.9mm

Fits to ID-10 mm nylon hose
 Continuous Working T°: -30°C to 120°C
 Working Pressure: 5-7bars

B63 7.89-ID6 Lengthen M



Fir Tree OD-8.9mm

Fits to ID-6 mm nylon hose
 Continuous Working T°: -30°C to 120°C
 Working Pressure: 5-7bars

B58 7.89-ID6-90° M

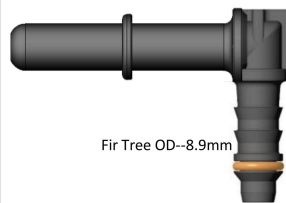

Fir Tree OD--8.9mm

Fits to ID-6 mm nylon hose
 Continuous Working T°: -30°C to 120°C
 Working Pressure: 5-7bars

B59 7.89-ID8-90° M

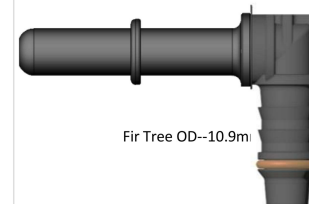

Fir Tree OD--10.9mm

Fits to ID-8 mm nylon hose
 Continuous Working T°: -30°C to 120°C
 Working Pressure: 5-7bars

Fuel system quick connector



FB1 7.89 Dust Cap



SAE7.89

DB2 7.89 Female End Cap



Continuous Working T°: -30°C to 120°C
Working Pressure: 5-7bars

SB1 7.89 Safety Lock



SAE7.89

DB1 7.89 male end cap

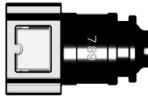

Continuous Working T°: -30°C to 120°C
Working Pressure: 5-7bars

DB2 7.89 lengthen male end cap



Continuous Working T°: -30°C to 120°C
Working Pressure: 5-7bars

Cooling system connector



BW3 7.89-ID8 Straight 0°



Fir Tree OD--10.9 mm

Fits to ID-8 mm nylon hose

Continuous Working T°: -30°C to 120°C
Working Pressure: 5-7bars

BW4 7.89-ID8 Elbow 90°



Fir Tree OD--10.9 mm

Fits to ID-8 mm nylon hose

Continuous Working T°: -30°C to 120°C
Working Pressure: 5-7bars

BW23 7.89-ID10 Straight 0°



Fir Tree OD--12.9 mm

Fits to ID-10 mm nylon hose

Continuous Working T°: -30°C to 120°C
Working Pressure: 5-7bars

BW24 7.89-ID10 Elbow 90°



Fir Tree OD--12.9 mm

Fits to ID-10 mm nylon hose

Continuous Working T°: -30°C to 120°C
Working Pressure: 5-7bars

BW25 7.89-ID8 Elbow 90°



Tube joint OD-9.13 mm

Fits to ID-8 mm Rubber hose

Continuous Working T°: -30°C to 120°C
Working Pressure: 5-7bars

BW26 7.89-ID8 Rubber E 90°



Tube joint OD-9.13 mm

Fits to ID-8 mm Rubber hose

Continuous Working T°: -30°C to 120°C
Working Pressure: 5-7bars

Urea reduction system connector



BU1 7.89-ID6 Straight 0°



Fir Tree OD--8.9mm

Fits to ID-6 mm nylon hose
 AdBlue® medium T°: -40°C to 70°C
 Working T°: -40°C to 120°C
 Working Pressure: 5-7bars

BU2 7.89-ID6 Elbow 90°



Fir Tree OD--8.9mm

Fits to ID-6 mm nylon hose
 AdBlue® medium T°: -40°C to 70°C
 Working T°: -40°C to 120°C
 Working Pressure: 5-7bars

BU3 7.89-ID8 Straight 0°



Fir Tree OD--10.9mm

Fits to ID-8 mm nylon hose
 AdBlue® medium T°: -40°C to 70°C
 Working T°: -40°C to 120°C
 Working Pressure: 5-7bars

BU4 7.89-ID8 Elbow 90°



Fir Tree OD--10.9mm

Fits to ID-8 mm nylon hose
 AdBlue® medium T°: -40°C to 70°C
 Working T°: -40°C to 120°C
 Working Pressure: 5-7bars

BU12 7.89-ID6 Rubber S 0°



Fir Tree OD--6.2 mm

Fits to ID-6 mm Rubber hose
 AdBlue® medium T°: -40°C to 70°C
 Working T°: -40°C to 120°C
 Working Pressure: 5-7bars

BU13 7.89-ID6 Rubber E 90°



Fir Tree OD--6.2 mm

Fits to ID-6 mm Rubber hose
 AdBlue® medium T°: -40°C to 70°C
 Working T°: -40°C to 120°C
 Working Pressure: 5-7bars

BU17 7.89-ID6 Straight 0°



Fir Tree OD--8.9mm

Fits to ID-6 mm nylon hose
 AdBlue® medium T°: -40°C to 70°C
 Working T°: -40°C to 120°C
 Working Pressure: 5-7bars

BU18 7.89-ID6 Elbow 90°



Fir Tree OD--8.9mm

Fits to ID-6 mm nylon hose
 AdBlue® medium T°: -40°C to 70°C
 Working T°: -40°C to 120°C
 Working Pressure: 5-7bars

BU9 7.89-ID3 Elbow 90°



Fir Tree OD--5.4mm

Fits to ID-3 mm nylon hose
 AdBlue® medium T°: -40°C to 70°C
 Working T°: -40°C to 120°C
 Working Pressure: 5-7bars

Urea reduction system connector



BU8 7.89-ID3 Straight 0°



Fir Tree OD-5.4mm

Fits to ID-3 mm nylon hose
AdBlue® medium T°: -40°C to 70°C
Working T°: -40°C to 120°C
Working Pressure: 5-7bars

BU25 7.89-ID8 Rubber S 0°



Tube joint OD-9.13 mm

Fits to ID-8 mm Rubber hose
AdBlue® medium T°: -40°C to 70°C
Working T°: -40°C to 120°C
Working Pressure: 5-7bars

BU26 7.89-ID8 Rubber E 90°



Tube joint OD-9.13 mm

Fits to ID-8 mm Rubber hose
AdBlue® medium T°: -40°C to 70°C
Working T°: -40°C to 120°C
Working Pressure: 5-7bars

Fuel system quick connector



D3 9.49-ID8 Straight 0°



Fir Tree OD-10.9mm

Fits to ID-8 mm nylon hose

Continuous Working T°: -30°C to 120°C
Working Pressure: 5-7bars

D4 9.49-ID8 Elbow 90°



Fir Tree OD-10.9mm

Fits to ID-8 mm nylon hose

Continuous Working T°: -30°C to 120°C
Working Pressure: 5-7bars

D5 9.49-ID8-45° 45°



Fir Tree OD-10.9mm

Fits to ID-8 mm nylon hose

Continuous Working T°: -30°C to 120°C
Working Pressure: 5-7bars

D6 9.49-ID6 Straight 0°



Fir Tree OD-8.9mm

Fits to ID-6 mm nylon hose

Continuous Working T°: -30°C to 120°C
Working Pressure: 5-7bars

D7 9.49-ID6 Elbow 90°



Fir Tree OD-8.9mm

Fits to ID-6 mm nylon hose

Continuous Working T°: -30°C to 120°C
Working Pressure: 5-7bars

D8 9.49-ID10 Straight 0°



Fir Tree OD-12.9mm

Fits to ID-10 mm nylon hose

Continuous Working T°: -30°C to 120°C
Working Pressure: 5-7bars

D9 9.49-ID10 Elbow 90°



Fir Tree OD-12.9mm

Fits to ID-10 mm nylon hose

Continuous Working T°: -30°C to 120°C
Working Pressure: 5-7bars

Fuel system quick connector



D10 9.49-ID3 Straight 0°

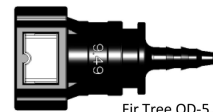

Fir Tree OD-5.4mm

Fits to ID-3 mm nylon hose

Continuous Working T°: -30°C to 120°C
Working Pressure: 5-7bars

D11 9.49-ID3 Elbow 90°



Fir Tree OD-5.4mm

Fits to ID-3 mm nylon hose

Continuous Working T°: -30°C to 120°C
Working Pressure: 5-7bars

D12 9.49-ID4 Straight 0°



Fir Tree OD-5.4mm

Fits to ID-4 mm nylon hose

Continuous Working T°: -30°C to 120°C
Working Pressure: 5-7bars

D13 9.49-ID4 Elbow 90°



Fir Tree OD-5.4mm

Fits to ID-4 mm nylon hose

Continuous Working T°: -30°C to 120°C
Working Pressure: 5-7bars

D14 9.49-ID6 Rubber S 45°



Fir Tree OD-6 mm

Fits to ID-6 mm Rubber hose

Continuous Working T°: -30°C to 120°C
Working Pressure: 5-7bars

D15 9.49-ID6 Rubber E 90°



Fir Tree OD-6 mm

Fits to ID-6 mm Rubber hose

Continuous Working T°: -30°C to 120°C
Working Pressure: 5-7bars

D16 9.49-ID8 Rubber S 0°

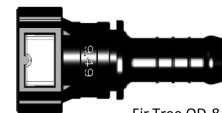

Fir Tree OD-8 mm

Fits to ID-8 mm Rubber hose

Continuous Working T°: -30°C to 120°C
Working Pressure: 5-7bars

D17 9.49-ID8 Rubber E 90°



Fir Tree OD-8 mm

Fits to ID-8 mm Rubber hose

Continuous Working T°: -30°C to 120°C
Working Pressure: 5-7bars

D18 9.49-ID10 Rubber S 0°



Fir Tree OD-10.5 mm

Fits to ID-10 mm Rubber hose

Continuous Working T°: -30°C to 120°C
Working Pressure: 5-7bars

Fuel system quick connector



D19 9.49-ID10 Rubber E 90°



Fir Tree OD-10.5 mm

Fits to ID-10 mm Rubber hose

Continuous Working T°: -30°C to 120°C
Working Pressure: 5-7bars

D20 9.49-ID6 -45 45°



Fir Tree OD-8.9mm

Fits to ID-6 mm nylon hose

Continuous Working T°: -30°C to 120°C
Working Pressure: 5-7bars

D21 9.49-ID10 -45 45°



Fir Tree OD-12.9mm

Fits to ID-10 mm nylon hose

Continuous Working T°: -30°C to 120°C
Working Pressure: 5-7bars

D22 9.49-ID12 Straight 0°



Fir Tree OD-14.8 mm

Fits to ID-12 mm nylon hose

Continuous Working T°: -30°C to 120°C
Working Pressure: 5-7bars

D23 9.49-ID12 Elbow 90°



Fir Tree OD-14.8 mm

Fits to ID-12 mm nylon hose

Continuous Working T°: -30°C to 120°C
Working Pressure: 5-7bars

D24 9.49-ID8 Rubber-45 45°



Fir Tree OD-9.13 mm

Fits to ID-10 mm Rubber hose

Continuous Working T°: -30°C to 120°C
Working Pressure: 5-7bars

D25 9.49-ID6 Rubber- 45 45°



Fir Tree OD-7.78 mm

Fits to ID-6 mm Rubber hose

Continuous Working T°: -30°C to 120°C
Working Pressure: 5-7bars

D26 9.49-ID10 Rubber- 45 45°



Fir Tree OD-10.5 mm

Fits to ID-10 mm Rubber hose

Continuous Working T°: -30°C to 120°C
Working Pressure: 5-7bars

DD1 9.49 Male End Cap

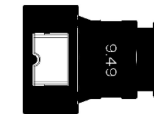

9.49

Continuous Working T°: -30°C to 120°C
Working Pressure: 5-7bars

Cooling water system quick connector



DW3 9.49-ID8 Straight 0°



Fir Tree OD-10.9mm

Fits to ID-8 mm nylon hose

Continuous Working T°: -30°C to 120°C
Working Pressure: 5-7bars

DW4 9.49-ID8 Elbow 90°



Fir Tree OD-10.9mm

Fits to ID-8 mm nylon hose

Continuous Working T°: -30°C to 120°C
Working Pressure: 5-7bars

DW8 9.49-ID10 Straight 0°

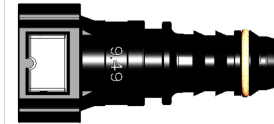

Fir Tree OD-12.9mm

Fits to ID-10 mm nylon hose

Continuous Working T°: -30°C to 120°C
Working Pressure: 5-7bars

DW9 9.49-ID10 Elbow 90°



Fir Tree OD-12.9mm

Fits to ID-10 mm nylon hose

Continuous Working T°: -30°C to 120°C
Working Pressure: 5-7bars

Urea reduction system connector



DU21 9.49-ID10 – 45° 45°



Fir Tree OD-12.9mm

Fits to ID-10 mm nylon hose

AdBlue® medium T°: -40°C to 70°C
Working T°: -40°C to 120°C
Working Pressure: 5-7bars

Urea reduction system connector



DU6 9.49-ID6 Straight 0°



Fir Tree OD-8.9mm

Fits to ID-6 mm nylon hose

AdBlue® medium T°: -40°C to 70°C
Working T°: -40°C to 120°C
Working Pressure: 5-7bars

DU7 9.49-ID6 Elbow 90°



Fir Tree OD-8.9mm

Fits to ID-6 mm nylon hose

AdBlue® medium T°: -40°C to 70°C
Working T°: -40°C to 120°C
Working Pressure: 5-7bars

DU3 9.49-ID8 Straight 0°



Fir Tree OD-10.9mm

Fits to ID-8 mm nylon hose

AdBlue® medium T°: -40°C to 70°C
Working T°: -40°C to 120°C
Working Pressure: 5-7bars

DU4 9.49-ID8 Elbow 90°



Fir Tree OD-10.9mm

Fits to ID-8 mm nylon hose

AdBlue® medium T°: -40°C to 70°C
Working T°: -40°C to 120°C
Working Pressure: 5-7bars

DU14 9.49-ID6 Rubber S 0°



Fir Tree OD-6 mm

Fits to ID-6 mm rubber hose

AdBlue® medium T°: -40°C to 70°C
Working T°: -40°C to 120°C
Working Pressure: 5-7bars

DU15 9.49-ID6 Rubber E 90°



Fir Tree OD-6 mm

Fits to ID-6 mm rubber hose

AdBlue® medium T°: -40°C to 70°C
Working T°: -40°C to 120°C
Working Pressure: 5-7bars

DU9 9.49-ID10 Elbow 90°



Fir Tree OD-12.9mm

Fits to ID-10 mm nylon hose

AdBlue® medium T°: -40°C to 70°C
Working T°: -40°C to 120°C
Working Pressure: 5-7bars

DU5 9.49-ID8 - 45° 45°



Fir Tree OD-10.9mm

Fits to ID-8 mm nylon hose

AdBlue® medium T°: -40°C to 70°C
Working T°: -40°C to 120°C
Working Pressure: 5-7bars

DU8 9.49-ID10 Straight 0°



Fir Tree OD-12.9mm

Fits to ID-10 mm nylon hose

AdBlue® medium T°: -40°C to 70°C
Working T°: -40°C to 120°C
Working Pressure: 5-7bars

Fuel system quick connector



E1 9.89-ID8 Straight 0°



Fir Tree OD-10.9mm

Fits to ID-8 mm nylon hose

Continuous Working T°: -30°C to 120°C
Working Pressure: 5-7bars

E2 9.89-ID8 Elbow 90°



Fir Tree OD-10.9mm

Fits to ID-8 mm nylon hose

Continuous Working T°: -30°C to 120°C
Working Pressure: 5-7bars

E3 9.89-ID10 Straight 0°



Fir Tree OD-12.9mm

Fits to ID-10 mm nylon hose

Continuous Working T°: -30°C to 120°C
Working Pressure: 5-7bars

E4 9.89-ID10 Elbow 90°



Fir Tree OD-12.9mm

Fits to ID-10 mm nylon hose

Continuous Working T°: -30°C to 120°C
Working Pressure: 5-7bars

E5 9.89-ID6 Straight 0°



Fir Tree OD-8.9mm

Fits to ID-6 mm nylon hose

Continuous Working T°: -30°C to 120°C
Working Pressure: 5-7bars

E6 9.89-ID6 Elbow 90°



Fir Tree OD-8.9mm

Fits to ID-6 mm nylon hose

Continuous Working T°: -30°C to 120°C
Working Pressure: 5-7bars

E7 9.89-ID8 Rubber S 0°



Fir Tree OD-9.13 mm

Fits to ID-8 mm rubber hose

Continuous Working T°: -30°C to 120°C
Working Pressure: 5-7bars

E8 9.89-ID8 Rubber E 90°



Fir Tree OD-9.13 mm

Fits to ID-8 mm rubber hose

Continuous Working T°: -30°C to 120°C
Working Pressure: 5-7bars

E9 9.89-ID10 Rubber S 0°



Fir Tree OD-11 mm

Fits to ID-10 mm rubber hose

Continuous Working T°: -30°C to 120°C
Working Pressure: 5-7bars

Fuel system quick connector



E10 9.89-ID10 Rubber E 90°



Fir Tree OD-11 mm

Fits to ID-10 mm rubber hose

Continuous Working T°: -30°C to 120°C
Working Pressure: 5-7bars

E11 9.89-ID8 -45° 45°



Fir Tree OD-10.9mm

Fits to ID-8 mm nylon hose

Continuous Working T°: -30°C to 120°C
Working Pressure: 5-7bars

E12 9.89-ID10 Rubber 45°



Fir Tree OD-11 mm

Fits to ID-10 mm rubber hose

Continuous Working T°: -30°C to 120°C
Working Pressure: 5-7bars

E13 9.89-ID6 -45° 45°



Fir Tree OD-8.9mm

Fits to ID-6 mm nylon hose

Continuous Working T°: -30°C to 120°C
Working Pressure: 5-7bars

E14 9.89-ID8 90° Tee



Fits to ID-8 mm nylon & ID-8 rubber hose

Continuous Working T°: -30°C to 120°C
Working Pressure: 5-7bars

E15 9.89-ID6 90° Tee



Fits to ID-6 mm nylon hose

Continuous Working T°: -30°C to 120°C
Working Pressure: 5-7bars

E16 9.89-ID8 90° Tee



Fits to ID-8 mm rubber & ID-8 nylon hose

Continuous Working T°: -30°C to 120°C
Working Pressure: 5-7bars

E18 9.89-ID10 90° Tee 90°



Fir Tree OD-12.9 mm

Fits to ID-10 mm nylon hose

Continuous Working T°: -30°C to 120°C
Working Pressure: 5-7bars

E19 9.89-ID10-ID10 Tee 90°



Fir Tree OD-12.9mm

Fits to ID-10 mm nylon hose

Continuous Working T°: -30°C to 120°C
Working Pressure: 5-7bars

cooling water system



EW1 9.89-ID8 Straight 0°



Fir Tree OD-10.9mm

Fits to ID-8 mm nylon hose

Continuous Working T°: -30°C to 120°C
Working Pressure: 5-7bars

EW2 9.89-ID8 Elbow 90°



Fir Tree OD-10.9mm

Fits to ID-8 mm nylon hose

Continuous Working T°: -30°C to 120°C
Working Pressure: 5-7bars

EW8 9.89-ID10 Straight 0°



Fir Tree OD-12.9mm

Fits to ID-10 mm nylon hose

Continuous Working T°: -30°C to 120°C
Working Pressure: 5-7bars

EW9 9.89-ID10 Elbow 90°



Fir Tree OD-12.9mm

Fits to ID-10 mm nylon hose

Continuous Working T°: -30°C to 120°C
Working Pressure: 5-7bars

Urea reduction system



EU1 9.89-ID8 Straight 0°



Fir Tree OD-10.9mm

Fits to ID-8 mm nylon hose

AdBlue® medium T°: -40°C to 70°C
Working T°: -40°C to 120°C
Working Pressure: 5-7bars

EU2 9.89-ID8 Elbow 0°



Fir Tree OD-10.9mm

Fits to ID-8 mm nylon hose

AdBlue® medium T°: -40°C to 70°C
Working T°: -40°C to 120°C
Working Pressure: 5-7bars

Multiple application connector



E51 9.89-ID6 M 0°



PA 6.0x8.0 or 5/16"

Continuous Working T°: -30°C to 120°C
Working Pressure: 5-7bars

E50 9.89-ID8 M 0°



PA 8.0x10.0 or 3/8"

Continuous Working T°: -30°C to 120°C
Working Pressure: 5-7bars

E53 9.89-ID9 M 90°



PA 9.0x12.0

Continuous Working T°: -30°C to 120°C
Working Pressure: 5-7bars

E52 9.89-ID10 M-B 0°



PA 10.0x12.0

Continuous Working T°: -30°C to 120°C
Working Pressure: 5-7bars

E54 9.89-ID10 M 90°



PA 10.0x12.0

Continuous Working T°: -30°C to 120°C
Working Pressure: 5-7bars

E55 9.89-ID6 Rubber M 90°



PA 10.0x12.0

Continuous Working T°: -30°C to 120°C
Working Pressure: 5-7bars

E56 9.89-ID8 Rubber M-B 0°



PA 10.0x12.0

Continuous Working T°: -30°C to 120°C
Working Pressure: 5-7bars

E57 9.89-ID10 Rubber M 90°



PA 10.0x12.0

Continuous Working T°: -30°C to 120°C
Working Pressure: 5-7bars

DE2 9.89 Female end plug 90°



PA 10.0x12.0

Continuous Working T°: -30°C to 120°C
Working Pressure: 5-7bars

Fuel system connector



G1 11.8-ID10 Straight 0°



Fits to ID-10 mm nylon hose

Continuous Working T°: -30°C to 120°C
Working Pressure: 5-7bars

G2 11.8-ID10 Elbow 90°



Fits to ID-10 mm nylon hose

Continuous Working T°: -30°C to 120°C
Working Pressure: 5-7bars

G3 11.80-ID10- 45° 45°



Fits to ID-10 mm nylon hose

Continuous Working T°: -30°C to 120°C
Working Pressure: 5-7bars

G4 11.8-ID8 Straight 0°



Fits to ID-8 mm nylon hose

Continuous Working T°: -30°C to 120°C
Working Pressure: 5-7bars

G5 11.8-ID8 Elbow 90°



Fits to ID-8 mm nylon hose

Continuous Working T°: -30°C to 120°C
Working Pressure: 5-7bars

G6 11.8-ID12 Straight 0°



Fits to ID-12 mm nylon hose

Continuous Working T°: -30°C to 120°C
Working Pressure: 5-7bars

G7 11.8-ID12 Elbow 90°



Fits to ID-12 mm nylon hose

Continuous Working T°: -30°C to 120°C
Working Pressure: 5-7bars

G8 11.80-ID12- 45° 45°



Fits to ID-12 mm nylon hose

Continuous Working T°: -30°C to 120°C
Working Pressure: 5-7bars

G9 11.8-ID10 Rubber S 0°



Fits to ID-10 mm rubber hose

Continuous Working T°: -30°C to 120°C
Working Pressure: 5-7bars

Cooling water system connector



GW1 11.80-ID10 Straight 0°



Fits to ID-10 mm nylon hose
Continuous Working T°: -30°C to 120°C
Working Pressure: 5-7bars

GW2 11.80-ID10 Elbow 90°



Fits to ID-10 mm nylon hose
Continuous Working T°: -30°C to 120°C
Working Pressure: 5-7bars

GW6 11.80-ID12 Straight 0°



Fits to ID-12 mm nylon hose
Continuous Working T°: -30°C to 120°C
Working Pressure: 5-7bars

GW7 11.80-ID12 Elbow 90°



Fits to ID-12 mm nylon hose
Continuous Working T°: -30°C to 120°C
Working Pressure: 5-7bars

Fuel system connector



F1 12.61-ID10 Straight 0°



Fits to ID-10 mm nylon hose

Continuous Working T°: -30°C to 120°C
Working Pressure: 5-7bars

F2 12.61-ID10 Elbow 90°



Fits to ID-10 mm nylon hose

Continuous Working T°: -30°C to 120°C
Working Pressure: 5-7bars

F3 12.61-ID12 Straight 0°



Fits to ID-12 mm nylon hose

Continuous Working T°: -30°C to 120°C
Working Pressure: 5-7bars

F4 12.61-ID12 Elbow 90°



Fits to ID-12 mm nylon hose

Continuous Working T°: -30°C to 120°C
Working Pressure: 5-7bars

F5 12.61-ID8 Straight 0°



Fits to ID-8 mm nylon hose

Continuous Working T°: -30°C to 120°C
Working Pressure: 5-7bars

F6 12.61-ID8 Elbow 90°



Fits to ID-8 mm nylon hose

Continuous Working T°: -30°C to 120°C
Working Pressure: 5-7bars

F7 12.61-ID10- 45° 45°



Fits to ID-10 mm nylon hose

Continuous Working T°: -30°C to 120°C
Working Pressure: 5-7bars

F8 12.61-ID12- 45° 45°



Fits to ID-12 mm nylon hose

Continuous Working T°: -30°C to 120°C
Working Pressure: 5-7bars

F11 12.61-ID6 Straight 0°



Fits to ID-6 mm nylon hose

Continuous Working T°: -30°C to 120°C
Working Pressure: 5-7bars

Multi-function application connector



F51 12.61-ID12 M 0°



Continuous Working T°: -30°C to 120°C
Working Pressure: 5-7bars

F53 12.61-ID10 M 90°



Continuous Working T°: -30°C to 120°C
Working Pressure: 5-7bars

FF1 12.61 0°



Continuous Working T°: -30°C to 120°C
Working Pressure: 5-7bars

F50 12.61-ID10 M 0°



Continuous Working T°: -30°C to 120°C
Working Pressure: 5-7bars

F54 12.61-ID8 M 0°



Continuous Working T°: -30°C to 120°C
Working Pressure: 5-7bars

F52 12.61-ID12 M 90°



Continuous Working T°: -30°C to 120°C
Working Pressure: 5-7bars

Fuel system connector



H1 15.82-ID12 Straight 0°



Fits to ID-12 mm nylon hose

Continuous Working T°: -30°C to 120°C
Working Pressure: 5-7bars

H2 15.82-ID12 Elbow 90°



Fits to ID-12 mm nylon hose

Continuous Working T°: -30°C to 120°C
Working Pressure: 5-7bars

H3 15.82-ID14 Straight 0°



Fits to ID-14 mm nylon hose

Continuous Working T°: -30°C to 120°C
Working Pressure: 5-7bars

H4 15.82-ID14 Elbow 90°



Fits to ID-14 mm nylon hose

Continuous Working T°: -30°C to 120°C
Working Pressure: 5-7bars

H5 15.82-ID12- 45° 45°



Fits to ID-12 mm nylon hose

Continuous Working T°: -30°C to 120°C
Working Pressure: 5-7bars

H6 15.82-ID14- 45° 45°



Fits to ID-14 mm nylon hose

Continuous Working T°: -30°C to 120°C
Working Pressure: 5-7bars

H7 15.82-ID14 Rubber S 0°

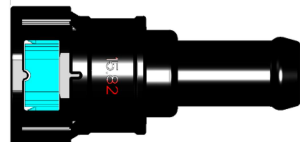

Fits to ID-14 mm rubber hose

Continuous Working T°: -30°C to 120°C
Working Pressure: 5-7bars

H8 15.82-ID14 Rubber E 90°

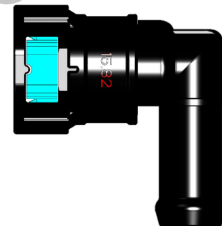

Fits to ID-14 mm rubber hose

Continuous Working T°: -30°C to 120°C
Working Pressure: 5-7bars

H9 15.82-ID14 Rubber - 45°

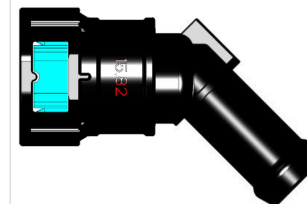

Fits to ID-14 mm rubber hose

Continuous Working T°: -30°C to 120°C
Working Pressure: 5-7bars

Fuel system connector



H13 15.82-ID12 Straight 0°



Fits to ID-12 mm nylon hose

Continuous Working T°: -30°C to 120°C
Working Pressure: 5-7bars

H14 15.82-ID12 Elbow 90°



Fits to ID-12 mm nylon hose

Continuous Working T°: -30°C to 120°C
Working Pressure: 5-7bars

H17 15.82-ID12- 45° 45°



Fits to ID-12 mm nylon hose

Continuous Working T°: -30°C to 120°C
Working Pressure: 5-7bars

H15 15.82-ID14 Straight 0°



Fits to ID-14 mm nylon hose

Continuous Working T°: -30°C to 120°C
Working Pressure: 5-7bars

H16 15.82-ID14 Elbow 90°



Fits to ID-14 mm nylon hose

Continuous Working T°: -30°C to 120°C
Working Pressure: 5-7bars

H18 15.82-ID14- 45° 45°



Fits to ID-14 mm nylon hose

Continuous Working T°: -30°C to 120°C
Working Pressure: 5-7bars

H20 15.82-ID8 Straight 0°



Fits to ID-8 mm nylon hose

Continuous Working T°: -30°C to 120°C
Working Pressure: 5-7bars

H19 15.82-ID10 Straight 0°



Fits to ID-10 mm nylon hose

Continuous Working T°: -30°C to 120°C
Working Pressure: 5-7bars

H22 15.82-ID16 Elbow 90°



Fits to ID-16 mm nylon hose

Continuous Working T°: -30°C to 120°C
Working Pressure: 5-7bars

Cooling water system connector



HW1 15.82-ID12 Straight 0°



Fits to ID-12 mm nylon hose
 Continuous Working T°: -30°C to 120°C
 Working Pressure: 5-7bars

HW2 15.82-ID12 Elbow 90°



Fits to ID-12 mm nylon hose
 Continuous Working T°: -30°C to 120°C
 Working Pressure: 5-7bars

HW3 15.82-ID14 Straight 0°



Fits to ID-14 mm nylon hose
 Continuous Working T°: -30°C to 120°C
 Working Pressure: 5-7bars

HW4 15.82-D14 Elbow 90°



Fits to ID-14 mm nylon hose
 Continuous Working T°: -30°C to 120°C
 Working Pressure: 5-7bars

HW5 15.82-ID12 - 45° 45°



Fits to ID-12 mm nylon hose
 Continuous Working T°: -30°C to 120°C
 Working Pressure: 5-7bars

HW6 15.82-ID14 45° 45°



Fits to ID-14 mm nylon hose
 Continuous Working T°: -30°C to 120°C
 Working Pressure: 5-7bars

H12 15.82-15.82-15.82 tee

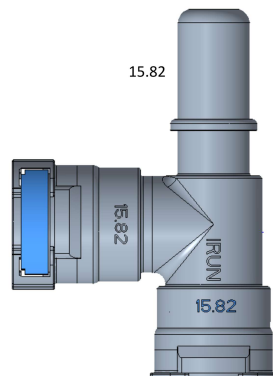

H10 11.8-11.8-15.82 tee

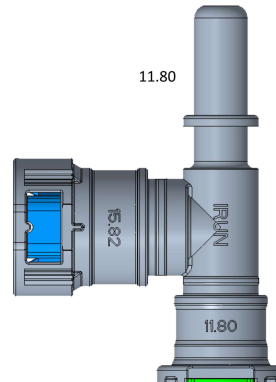

H11 15.82-11.8-11.8 tee

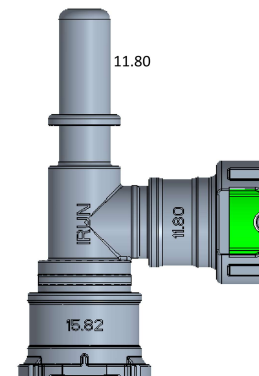

Multi-function application connector



H50 15.82-ID12M 0°



Fits to ID-12 mm nylon hose
Continuous Working T°: -30°C to 120°C
Working Pressure: 5-7bars

H70 15.82-ID14 M 0°



Fits to ID-14 mm nylon hose
Continuous Working T°: -30°C to 120°C
Working Pressure: 5-7bars

HF1 15.82 Dust Plug



H52 15.82-ID16 Rubber M 0°



Fits to ID-16 mm rubber hose
Continuous Working T°: -30°C to 120°C
Working Pressure: 5-7bars

H71 15.82-ID10M 0°



Fits to ID-10 mm nylon hose
Continuous Working T°: -30°C to 120°C
Working Pressure: 5-7bars

HD1 15.82 End cap 0°



Continuous Working T°: -30°C to 120°C
Working Pressure: 5-7bars

H52 15.82 Protective jacket 0°



Fits to ID-10 mm nylon hose
Continuous Working T°: -30°C to 120°C
Working Pressure: 5-7bars

HZF1 15.82-ID21- ID21 90°
Stop Valve



Fits to ID-21-21 mm nylon hose
Continuous Working T°: -30°C to 120°C
Working Pressure: 5-7bars

Fuel oil system connector



NG1 NG8-ID7 Straight 0°

Fir Tree OD-10.2mm

Tube joint OD--12mm

Fits to ID-7 mm nylon hose

Continuous Working T°: -30°C to 120°C
Working Pressure: 5-7bars

NG2 NG8-ID7 Elbow 90°

Fir Tree OD-10.2mm

Tube joint OD--12mm

Fits to ID-7 mm nylon hose

Continuous Working T°: -30°C to 120°C
Working Pressure: 5-7bars

NG3 NG12-ID9 Straight 0°

Fir Tree OD-11.3mm

Tube joint OD--16mm

Fits to ID-9 mm nylon hose

Continuous Working T°: -30°C to 120°C
Working Pressure: 5-7bars

NG4 NG12-ID9 Elbow 90°

Fir Tree OD-11.3mm

Tube joint OD-16mm

Fits to ID-9 mm nylon hose

Continuous Working T°: -30°C to 120°C
Working Pressure: 5-7bars

NG5 NG12-ID10 Straight 0°

Fir Tree OD-12.3mm

Tube joint OD--16mm

Fits to ID-10 mm nylon hose

Continuous Working T°: -30°C to 120°C
Working Pressure: 5-7bars

NG6 NG12-ID10 Elbow 90°

Fir Tree OD-12.3mm

Tube joint OD--16mm

Fits to ID-10 mm nylon hose

Continuous Working T°: -30°C to 120°C
Working Pressure: 5-7bars

NG7 NG12-ID12 Straight 0°

Fir Tree OD-14.8mm

Tube joint OD--16mm

Fits to ID-12 mm nylon hose

Continuous Working T°: -30°C to 120°C
Working Pressure: 5-7bars

NG8 NG12-ID12 Elbow 90°

Fir Tree OD-14.8mm

Tube joint OD--16mm

Fits to ID-12 mm nylon hose

Continuous Working T°: -30°C to 120°C
Working Pressure: 5-7bars

NG9 NG8-ID6 Straight 0°

Fir Tree OD-8.6mm

Tube joint OD--12mm

Fits to ID-6 mm nylon hose

Continuous Working T°: -30°C to 120°C
Working Pressure: 5-7bars

Fuel oil system connector



NG10 NG8-ID6 Elbow 90°

Fir Tree OD-8.6mm
Tube joint OD-12mm

Fits to ID-6 mm nylon hose

Continuous Working T°: -30°C to 120°C
Working Pressure: 5-7bars

NG11 NG12-ID8 Straight 0°

Fir Tree OD-10.6mm
Tube joint OD-16mm

Fits to ID-8 mm nylon hose

Continuous Working T°: -30°C to 120°C
Working Pressure: 5-7bars

NG12 NG12-ID8 Elbow 90°

Fir Tree OD-10.6mm
Tube joint OD-16mm

Fits to ID-8 mm nylon hose

Continuous Working T°: -30°C to 120°C
Working Pressure: 5-7bars

NG13 NG12-ID12 Straight 0°

Fir Tree OD-14.8mm
Tube joint OD-16.3mm

Fits to ID-12 mm nylon hose

Continuous Working T°: -30°C to 120°C
Working Pressure: 5-7bars

NG14 NG12-ID12 Elbow 90°

Tube joint OD 16.3mm
Fir Tree OD-14.8mm

Fits to ID-12 mm nylon hose

Continuous Working T°: -30°C to 120°C
Working Pressure: 5-7bars

NG15 NG12-ID6 Straight 0°

Fir Tree OD-8.6mm
Tube joint OD-16mm

Fits to ID-6 mm nylon hose

Continuous Working T°: -30°C to 120°C
Working Pressure: 5-7bars

1106 NG8-NW6 Straight 0°

Fir Tree OD-8.6mm
Tube joint OD-9.5mm

Fits to ID-6 mm nylon hose

Continuous Working T°: -30°C to 120°C
Working Pressure: 5-7bars

1201 NG8-NW6 Elbow 90°

Fir Tree OD-8.6mm
Tube joint OD-9.5mm

Fits to ID-6 mm nylon hose

Continuous Working T°: -30°C to 120°C
Working Pressure: 5-7bars

NG16 NG12-ID6 Elbow 90°

Fir Tree OD-8.6mm
Tube joint OD-16mm

Fits to ID-6 mm nylon hose

Continuous Working T°: -30°C to 120°C
Working Pressure: 5-7bars

Fuel oil system connector



1101 NG12NW9 Straight 0°

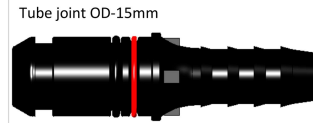

Tube joint OD-15mm
Fits to ID-9 mm nylon hose
Continuous Working T°: -30°C to 120°C
Working Pressure: 5-7bars

1204 NG12-NW9 Elbow 90°

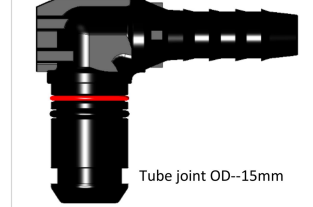

Tube joint OD--15mm
Fits to ID-9 mm nylon hose
Continuous Working T°: -30°C to 120°C
Working Pressure: 5-7bars

1110 NG12 NW12 Straight 0°

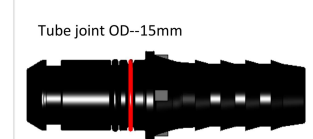

Tube joint OD--15mm
Fits to ID-12 mm nylon hose
Continuous Working T°: -30°C to 120°C
Working Pressure: 5-7bars

1203 NG12-NW12 Elbow 90°

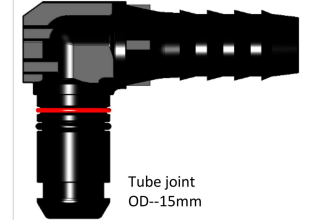

Tube joint OD--15mm
Fits to ID-12 mm nylon hose
Continuous Working T°: -30°C to 120°C
Working Pressure: 5-7bars

1104 NG12-NW6 Straight 0°

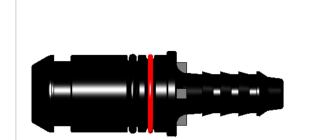

Tube joint OD--15mm
Fits to ID-6 mm nylon hose
Continuous Working T°: -30°C to 120°C
Working Pressure: 5-7bars

1202 NG12-NW6 Elbow 90°

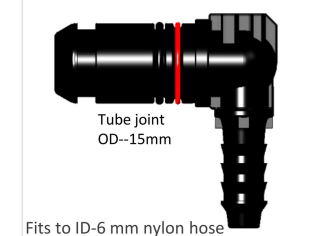

Tube joint OD--15mm
Fits to ID-6 mm nylon hose
Continuous Working T°: -30°C to 120°C
Working Pressure: 5-7bars

1301 NG12-NW6-45 45°

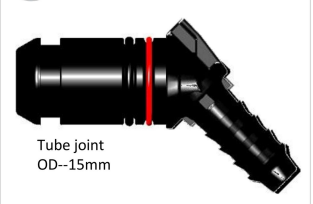

Tube joint OD--15mm
Fits to ID-6 mm nylon hose
Continuous Working T°: -30°C to 120°C
Working Pressure: 5-7bars

1106-10 NG8-10-NW6 Straight 0°

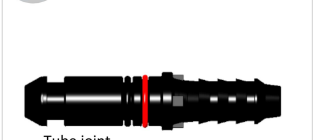

Tube joint OD--10mm
Fits to ID-6 mm nylon hose
Continuous Working T°: -30°C to 120°C
Working Pressure: 5-7bars

1201-10 NG8-10-NW6 Elbow 90°

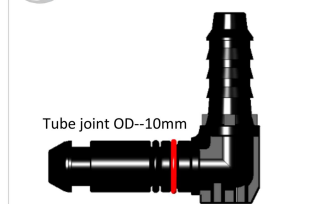

Tube joint OD--10mm
Fits to ID-6 mm nylon hose
Continuous Working T°: -30°C to 120°C
Working Pressure: 5-7bars

Fuel oil system connector 246 Generation 2



NG2 NG8-ID8 Elbow 90°



Fits to ID-8 mm nylon hose
Continuous Working T°: -30°C to 120°C
Working Pressure: 5-7bars

NG8 NG12-ID12 Elbow 90°



Fits to ID-12 mm nylon hose
Continuous Working T°: -30°C to 120°C
Working Pressure: 5-7bars

NG9 NG8-ID6 Straight 0°



Fits to ID-6 mm nylon hose
Continuous Working T°: -30°C to 120°C
Working Pressure: 5-7bars

NG10 NG8-ID6 Elbow 90°



Fits to ID-6 mm nylon hose
Continuous Working T°: -30°C to 120°C
Working Pressure: 5-7bars

NG12 NG12-ID8 Elbow 90°



Fits to ID-8 mm nylon hose
Continuous Working T°: -30°C to 120°C
Working Pressure: 5-7bars

Fuel system quick connector



A1 6.30-ID3 Straight 0°



Fir Tree OD-- 5.4mm

Fits to ID-3 mm nylon hose

Continuous Working T°: -30°C to 120°C
Working Pressure: 5-7bars

A2 6.30-ID3 Elbow 90°



Fir Tree OD-- 5.4mm

Fits to ID-3 mm nylon hose

Continuous Working T°: -30°C to 120°C
Working Pressure: 5-7bars

A3 6.30-ID6 Straight 0°



Fir Tree OD-- 8.9mm

Fits to ID-6 mm nylon hose

Continuous Working T°: -30°C to 120°C
Working Pressure: 5-7bars

A4 6.30-ID6 Elbow 90°



Fir Tree OD-- 8.9mm

Fits to ID-6 mm nylon hose

Continuous Working T°: -30°C to 120°C
Working Pressure: 5-7bars

A5 6.30-ID4 Straight 0°



Fir Tree OD--5.4mm

Fits to ID-4 mm nylon hose

Continuous Working T°: -30°C to 120°C
Working Pressure: 5-7bars

A6 6.30-ID4 Elbow 90°



Fir Tree OD--5.4mm

Fits to ID-4 mm nylon hose

Continuous Working T°: -30°C to 120°C
Working Pressure: 5-7bars

A7 6.30-ID5 Straight 0°



Fir Tree OD--6.5mm

Fits to ID-5 mm nylon hose

Continuous Working T°: -30°C to 120°C
Working Pressure: 5-7bars

A8 6.30-ID5 Elbow 90°



Fir Tree OD--6.5mm

Fits to ID-5 mm nylon hose

Continuous Working T°: -30°C to 120°C
Working Pressure: 5-7bars

A9 6.30-ID6 Rubber S 0°



OD--5.4mm

Fits to ID-6mm rubber hose

Continuous Working T°: -30°C to 120°C
Working Pressure: 5-7bars